

**TECHNICAL INFORMATION:****Teknik Bilgiler / Technical Information / المواصفات التقنية**

Modeller / Models / الموديل	250x250
Panel Yüksekliği / Panel Height / ارتفاع اللوحة	Min 1000 mm / Max 2500 mm
Panel Geniřliđi / Panel Height / عرض اللوحة	Min 1500 mm / Max 2500 mm
Tel Kalınlıđı / Wire Thickness / سماكة السلك	Min - 3 mm / Max - 5 mm
Göz Aralıkları / Eye Spaces / مسافة العين (x)	Min - 45 mm / Max - 100 mm
Göz Aralıkları / Eye Spaces / مسافة العين (y)	Min - 20 mm / Max - 300 mm

- Mesh Piston Cylinder: 22 pieces
- Mesh Piston Coppers: Zirconium
- Length Wire Arrangement (Vertical): Automatic
- Press Bending: Automatic
- Installation Area: 10 m x 25 m

- / Mesh Welding Point: 44 Points
- / Mesh Coppers: Zirconium
- / Wire Arrangement (Horizontal): Automatic
- / Stacking Robot : Automatic
- / Total Weight: 7.000 Kg

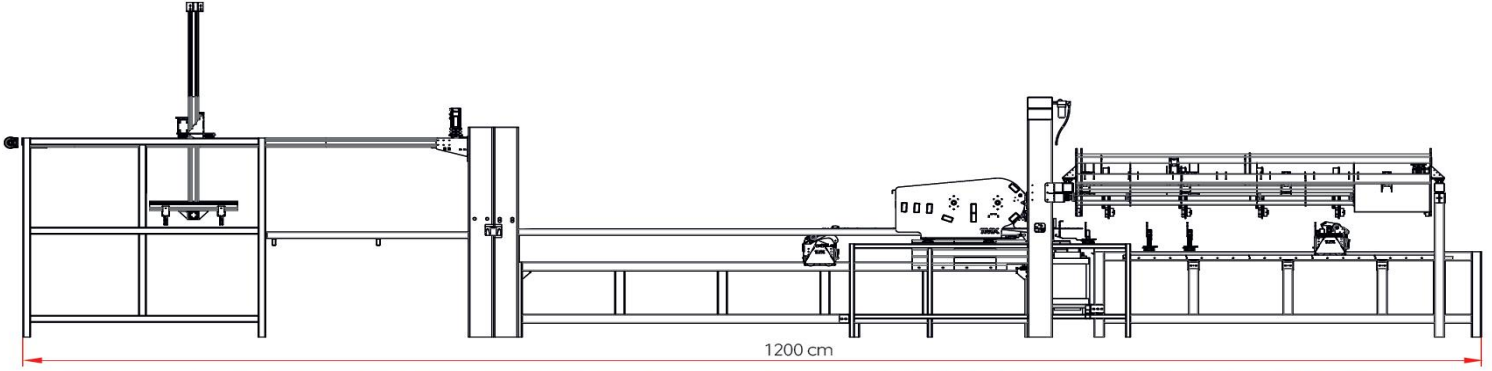



Information Can Be Optional Changed According to Needs. Please Inform Your Special Requests.

## **AUTOMATIC BENDING PRESS AND STACKING INFORMATION:**

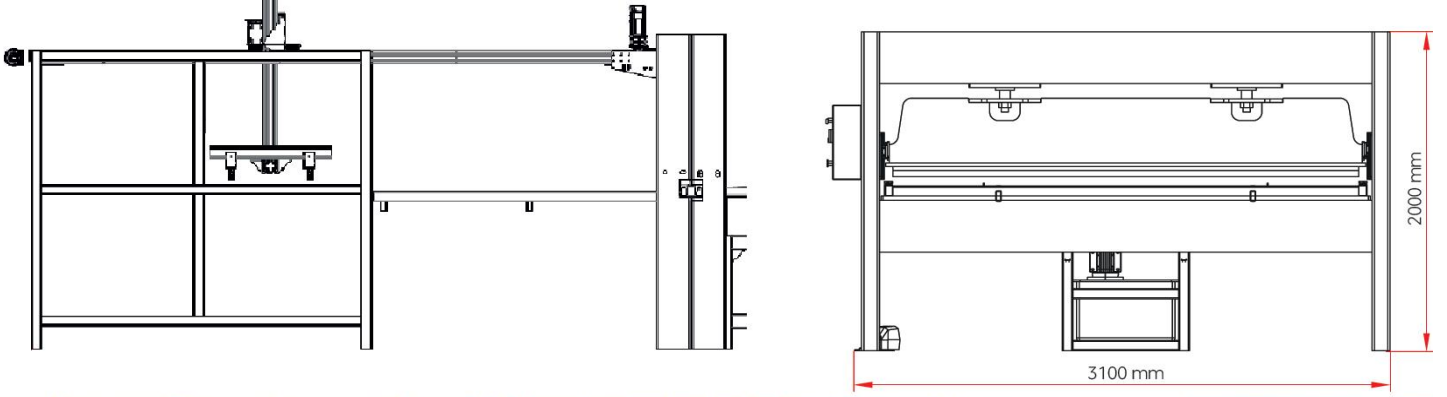

### **Teknik Bilgiler / Technical Information / المواصفات التقنية**

Modeller / Models / الموديل	TMX - BP
Tel Bükme Ebatı / Wire Bending Dimensions / ابعاد لوحة التني	Min 500 mm / Max 2500 mm
Alt Tabla Ebatı / Bottom Table Dimensions / ابعاد الطاولة السفلى	2750 mm x 300 mm
Makine Çalışma Sistemi / Machine Work System / نظام عمل الماكينة	Hidrolik - Hydraulic
Makine Ölçüsü / Machine Dimensions / ابعاد الماكينة	3500 x 750 x 2000 mm
Tel Kalınlığı / Wire Thickness / سماكة السلك	Min 2 mm / Max 5 mm
Pompa Hacmi / Pump Size / حجم الضاغط	42 lt
Toplam Güç / Total Power / اجمالي الطاقة	5 kVA
Makine Voltaj / Machine Voltage / فولتية الماكينة	380 V
Makine Ağırlığı / Machine Weight / وزن الماكينة	1800 Kg
Kapasite / Capacity / الطاقة الانتاجية	18 mm saniye - adet / second -pieces

- **Automation System: Motion System** / **Automation Elements: Siemens - Schlatter**
- **Wire Bending Type: Single – Double** / **Wire Bending Type : Standard / Special**
- **Stacking Robot: X – Z Axis** / **Stacking Quantity: 100 Pcs. Max.**



## ELECTRONIC INFORMATION:



- Automation System: Motion System
- Control Panel : 15" Touch
- 10 kVa UPS

/  
/  
/

- Automation Elements: Siemens – Schlatter
- Programming : Automatic
- Chiller

**Note : UPS and Water Chiller machine are provided free of charge.**



## SOURCE ENERGY INFORMATION:



- Transformer Power: 150 kW /
- Nominal Primary Voltage: 400 V / 50 /
- Nominal Secondary Voltage: 8.6 - 9.3 V /
- Trigger Type: Thyristor 512A /
- Total Power: 900 kVa /
- Cooling Type: Chiller /
- Cooling Pressure: 8 Lt / Bar /
- Number of Transformers: 6 Pieces
- Nominal Primary Current: 325A
- Nominal 50% Current: 16.2kA
- Trigger Connection: 6 Tr x 1
- Mains Power Min. : 250 kVa 600 A
- Cooling Type: Water + Antifreeze
- Cooling Degree: 22 – 25 C

Information Can Be Optional Changed According to Needs. Please Inform Your Special Requests.

## AIR SYSTEM INFORMATION:

- System Supply: Screw Compressor /
- System Air Dryer : Yes /
- Consumption: 250 Lt/min /
- System Tank: 1000 LT
- Air Pressure Min : 6 Bar
- Air Pressure Max: 8 Bar

## PRODUCTION CAPACITY INFORMATION:

Calculated Product Properties

Wire Thickness: 4 mm

- Wire Length: 120 cm /
- Length Wire Quantity: 44 Pieces /
- Length Wire Spacing: 50 mm /
- Twist: Automatic /
- Wire Width: 250 cm
- Width Wire Quantity: 14 Pieces
- Width Wire Spacing: 150 mm
- Number of Twists: 3 Twists

**1.2 m x 2.5 m : 3.000 m<sup>2</sup> / 8 Hours**

