

VHZ

Energy-efficient wood shredding

The small series VHZ is a durable and robust shredding solution specially developed for the needs of the wood-processing industry. Joiners, carpenters and wood-workers benefit from the reliable shredding components, which, thanks to our patented drive technology, set new standards for energy efficiency, designed to ensure lowest operating costs.



Small, but mighty – VHZ series 600–1300

The single-shaft shredder VHZ is compact and universally designed for a wide range of waste wood applications. For five decades, Vecoplan has been a reliable global partner for efficient and cost-effective shredding solutions.

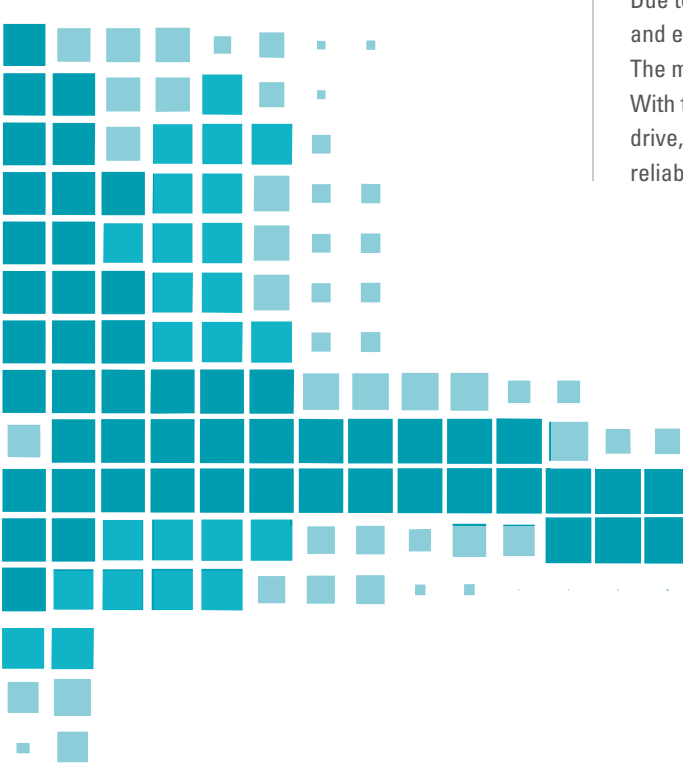

Due to its practical experience Vecoplan has developed this robust and energy-efficient machine in a compact design for easy use. The machine is particularly appreciated by joiners and carpenters. With the patented ESC-Drive, the machine features a gearless drive, for energy and economic efficiency and high operational reliability.

The solution for wood-processing plants



Input material

- Particle board
- MDF board
- OSB board
- Hardwood waste
- Softwood waste
- Solid wood waste
- Bark

Output material

- Shredded particles for energetic use
- Material for briquette production

Tireless – Precise – Robust

Shredding components by Vecoplan

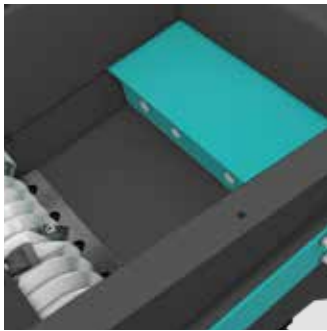

Ram

- Optimum ram geometry
- Hydraulic material supply
- Spring pre-loaded ram sealing



Control cabinet

- Efficient and innovative control with automatic performance adjustment (material detection)
- No peak currents



ESC®-Drive

- Main drive with frequency converter, for adjustable rotor speed
- Low energy consumption
- High drive dynamics by fast reversing and re-start
- Drive belt slip control
- Tramp metal protection
- Variable speed range allows adjustment of throughput capacity



Material discharge

- Equipped for mechanical and pneumatic discharge

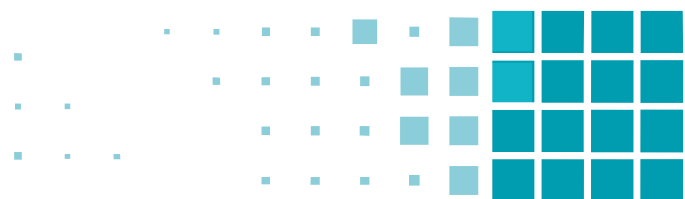

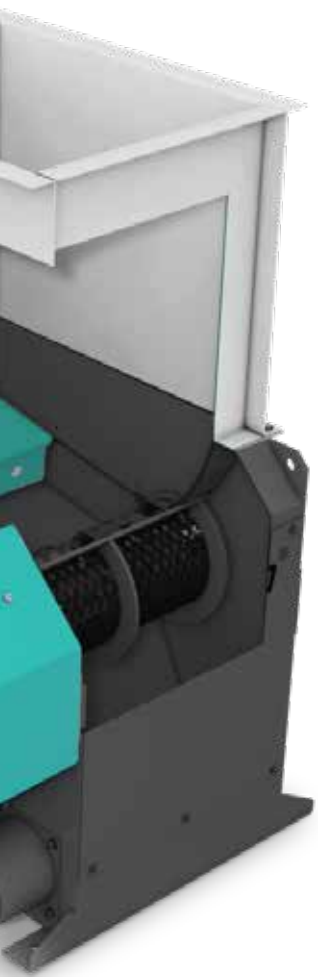

Hydraulics

- Compact hydraulic unit integrated in the machine support frame
- Easy access by modular-system
- VHZ 1300 S: Simple accessibility due to slide-in technology directly at the machine

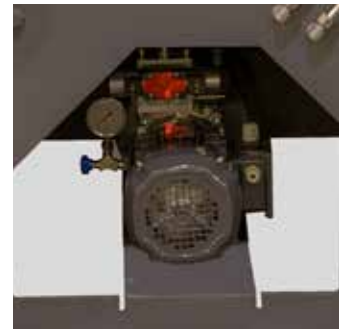

Rotor/Cutting unit

- Patented, profiled rotor for efficient shredding
- Easy-to-change profiled counter knife
- Integrated log spacer



Bearing

- Heavy-duty steel rotor housing with dust discharge

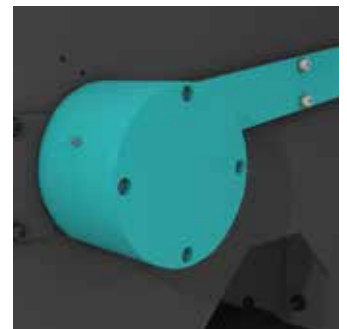

Plug and Play

- Control panel secured to the shredder for easy transport
- Factory pre-wired and supplied with brackets for wall mounting



ESC[®]-Drive – an investment, that pays off

With the ESC-Drive, Vecoplan has been able to develop machines with an energy-efficient, cost-effective and economical drive of 11 to 37 kW motor power. The asynchronous drive motor with a powerful frequency converter works together with a high-performance belt drive featuring sophisticated slip control and tramp metal protection. The patented drive technology ensures productive and durable operation of the shredder with a convincing economic energy profile.

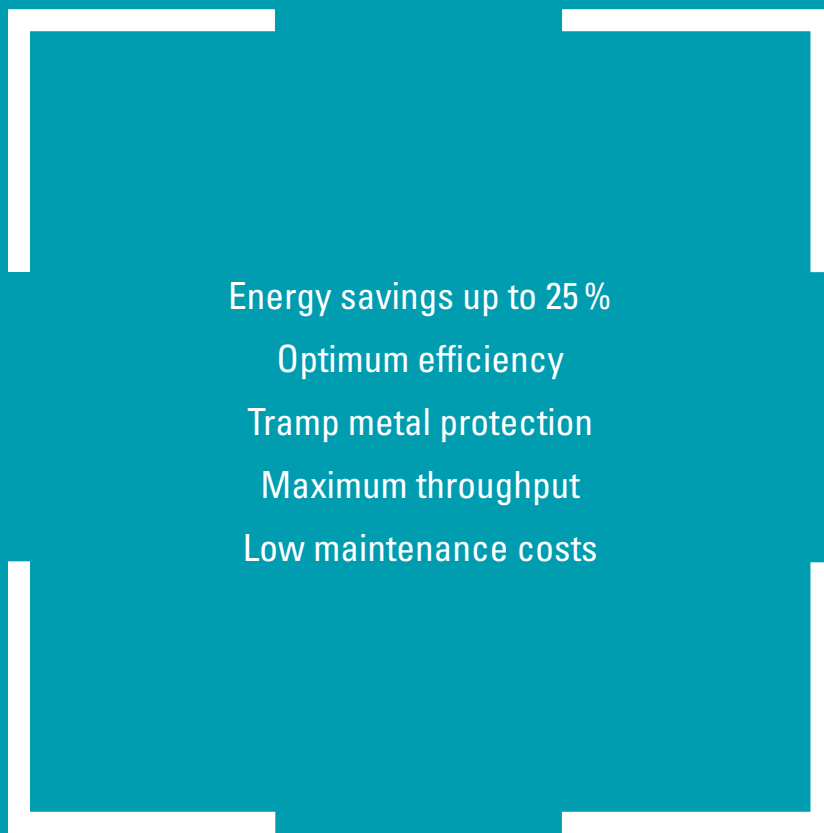

Features and performance



Details		VHZ 600	VHZ 800	VHZ 1100	VHZ 1100 XL	VHZ 1300 S
Infeed opening (W×L)	mm	620×800	800×950	1075×950	1075×1200	1310×1200
Rotor dimensions	mm	∅ 250×610	∅ 250×790	∅ 250×1065	∅ 370×1065	∅ 370×1300
Rotor speed	rpm	90–250	90–250	90–250	90–265	90–265
Number of counter knives	pcs.	1	2	2	2	3
Number of cutters	single	pcs.	14	20	27	33
	double		28	40	54	66
Motor power (frequency converter)	kW	11 (15); 15 (22)	15 (22); 18,5 (22)	18,5 (22); 22 (30)	30 (37); 37 (55)	45 (55)
Total weight (incl. feed hopper)	kgs	1,3	1,6	1,85	3	4,3
Screen hole size	mm	10–40	10–40	10–50	10–50	10–50
Dimensions (W×H×L)	mm	1170×980×1970	1348×980×2340	1623×980×2340	1693×1150×2660	1922×1150×2660
Pneumatic pick up ∅	mm	200	200	200	250	250

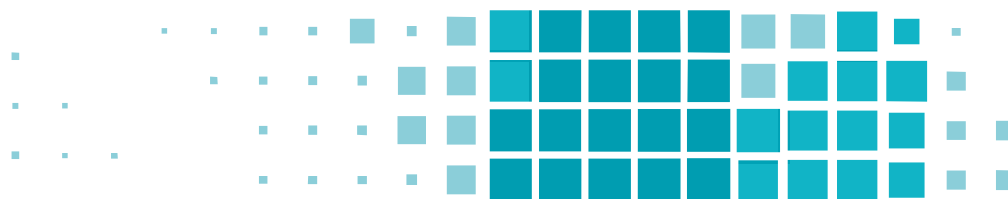

Vecoplan®

Vecoplan AG
Vor der Bitz 10
56470 Bad Marienberg | Germany
phone +49 2661 62 67-0
fax +49 2661 62 67-70
welcome@vecoplan.de
www.vecoplan.com